

# CIRCULAR KNIVES.

## TOP KNIVES (FLAT).

Type NF (normal bevel), SF (double bevel), SHF (double hollow bevel), SPF (special bevel)

Outer-Ø (D1) mm	Inner-Ø (D2) mm	Thickness (S1) mm
90	60	1.2
105	65 / 70 / 75	1.2 / 1.5 / 2
150	80 / 120	1.5 / 2.5
180	70	3 / 5
190	75	1.5 / 2 / 3
200	65 / 70 / 80 / 90	2 / 2.5 / 3 / 5
220	80 / 90 / 120 / 180	3 / 5

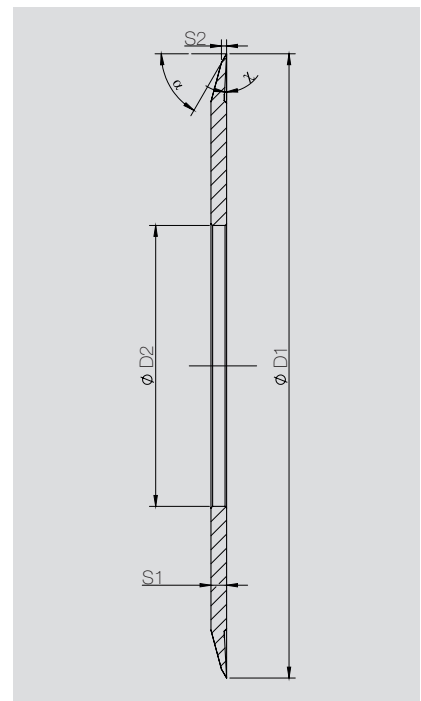

Standard cutting angle: 30° / 45° / 60° ( $\alpha$ )

Other dimensions and materials on request.

### Standard materials:

chrome alloyed (1.5 % Cr), high chrome alloyed tool steel (12 % Cr) and powder metallurgical high-speed steel

### Benefits:

- | highest slitting performance due to ideal surface finish
- | long service life due to matched material qualities
- | usable for different machine types
- | exact production tolerances
- | DIENES precision grinding "CONTROLLEUR"
- | regrindable in manufacturer quality

DIENES also manufactures the corresponding bottom knives, knife holders and slitting systems.

